

Heritage Garden circa 1880 - 1889

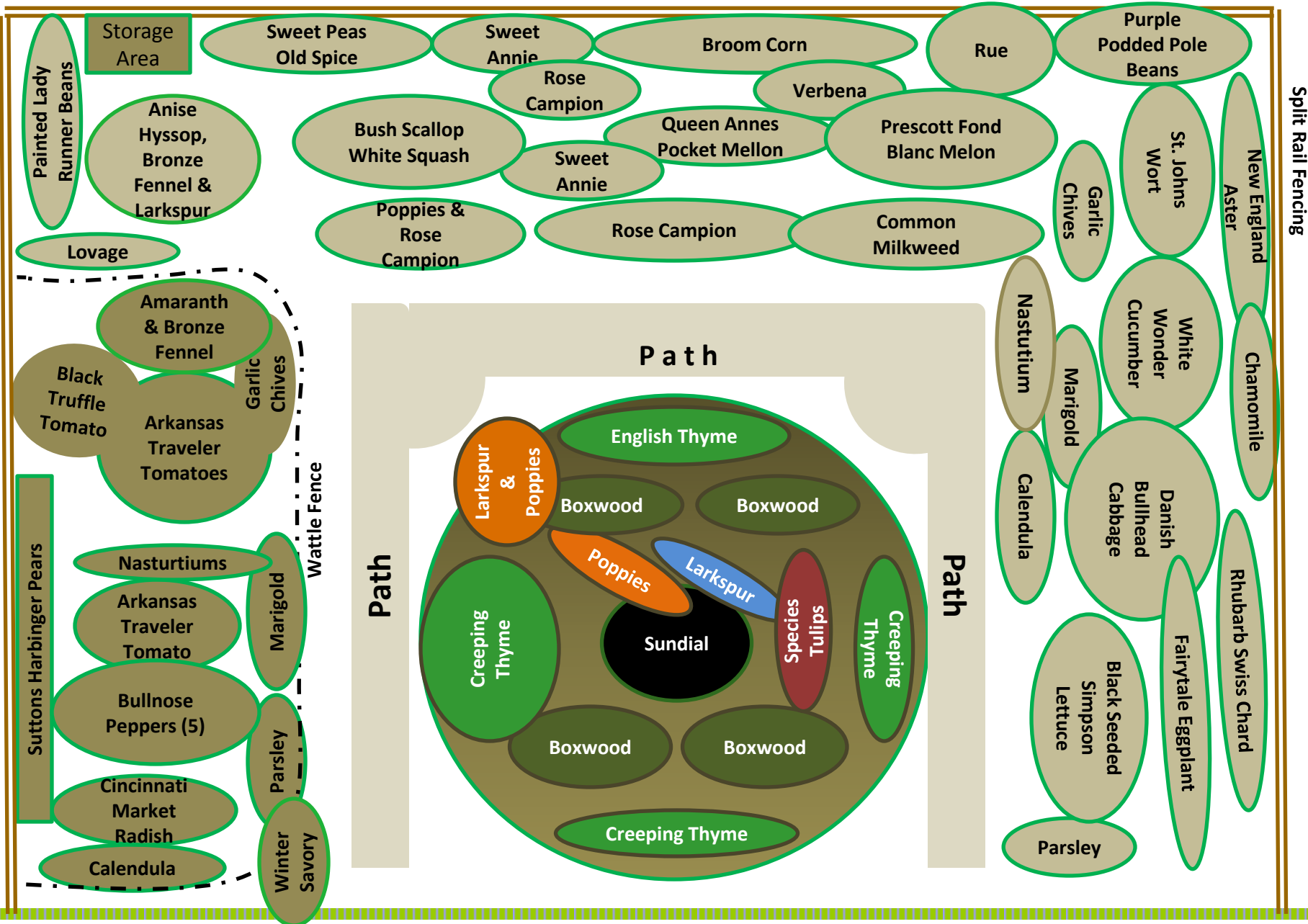

2013 - Note: Garden subject to change due to weather, wildlife, etc

Heritage Garden c 1880-1890

The Heritage garden was created by the Master Gardener's 5 years ago to showcase herb, vegetable and edible flower varieties popular in the early 18th century in colonial Virginia. Each year thereafter the garden has moved forward in time and this year popular varieties from the late 19th century are being grown. The Heritage garden resembles a kitchen garden as plants are intermingled in loosely arranged beds. Some plants are ornamental like the boxwoods in the center, some are perennial like many of the herbs and some are planted seasonally such as the vegetables.

Hardscape features of the garden include the sundial in the middle, the split rail fencing around the garden, the wattle fence on the left side and the tomato table built to support the tomatoes in the left bed.

The wattle fence surrounding the beds on the left side was built of willow saplings during the spring and can be expected to last a couple of seasons. Alder saplings are another sapling which stays flexible for a long time but any sapling can be used in the green stage if used immediately. Historically wattle fences have been used since medieval times and are a low cost way to enclose areas. The tomato table was built of willow saplings and will be built higher up as the tomato plants gain height.

Plants in the garden this season include:

Vegetables

Bean - Pole, Kentucky Blue Lake and Purple Podded
Beans - Runner, Painted Lady
Broom Corn
Cabbage, Danish Ballhead
Chard, Rhubarb
Cucumber, White Wonder
Eggplant, Fairytale
Lettuce, Black Seeded Simpson, Red Deer Tongue, Oakleaf
Melon, Prescott Fond Blanc & Queen Anne's Pocket
Peas - Shelling, Suttons Harbinger
Peppers, Bullnose
Radish, Cincinnati Market and China Rose
Squash, Scallop White Squash
Tomatoes, Arkansas Traveler & Black Truffle

Other Ornamentals, Herbs and Edible Flowers:

Anise Hyssop	Marigold, French
Basil	Nasturtiums
Boxwood	New England Aster
Bronze Fennel	Parsley
Chamomile	Poppies, Flemish
Calendula	Antique
Creeping Thyme	Rose Campion
Common Milkweed	Rue
Daylily	Species Tulips
English Thyme	St John's Wort
Garlic Chives	Sweet Annie
Larkspur	Sweet Peas, Old Spice
Lovage	Verbena

For copies of this flyer, visit the Demo Garden page on our website: www.loudouncountymastergardeners.org and click on the Heritage Garden in the interactive map.